

# Heat Recovery Ventilator VH30160

**CLEAN COMFORT™**  
INDOOR AIR ESSENTIALS

## Features

- Three operating modes (Intermittent, Continuous and High)
- 100% variable speed
- Integrated door pressure balancing taps
- ISF™ (Insert, Slide and Fix) 6" (153 mm) dia. collar system
- Advanced proportional supply fan shut-down defrost sequence
- Factory-installed, adjustable hanging strap system
- Dual permanently lubricated PSC motors
- Integrated auxiliary furnace interlock relay
- Ventilator can be balanced by adjusting each motor independently; no balancing dampers required
- Connection terminals for optional wall controls
- Quiet operation

## Heat Recovery Core

- Transfers sensible heat
- Effective in warm and cold climates
- Water washable

## Certifications and Standards

- HVI Certified
- CSA C439 Standard (Packaged Heat/Energy Recovery Ventilators (HRV/ERV))
- CSA Standard CSA 22.2 NO.113-10 (Fans and ventilators)
- UL Standard 1812 2nd Ed. Ducted Heat/Energy Recovery Ventilators (HRV/ERV)



**Airflow** (Front View)

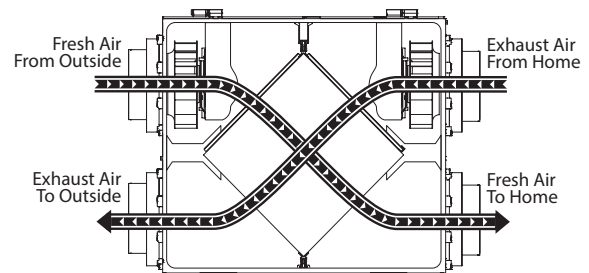

## Proprietary Notice

This document and the information disclosed herein are proprietary data of Daikin North America LLC. Neither this document nor the information contained herein shall be reproduced, used, or disclosed to others without the written authorization of Daikin North America LLC except to the extent required for installation or maintenance of recipient's equipment.

## Liability Notice

Daikin North America LLC does not accept any liability for installations of ventilation equipment installed by unqualified personnel or the use of parts/components/equipment that are not authorized or approved by Daikin.

## Copyright Notice

Copyright 2017, Daikin North America LLC All rights reserved.

## Specifications VH30160

### Cabinet

**Dimensions** 29<sup>1</sup>/<sub>2</sub>" x 22<sup>1</sup>/<sub>2</sub>" x 11<sup>1</sup>/<sub>8</sub>"  
(749.3 mm x 571.5 mm x 289 mm)

**Construction** 20-gauge galvanized pre-painted steel corrosion-resistant liner: molded expanded Polystyrene (EPS) Rated UL94 HF-1

**Duct Connections** Four, 6" (152.5 mm) dia. ISF double collar system

**Airflow Rates** 30 CFM (14 L/s) to 160 CFM (76 L/s)

**Motors** Two PSC variable-speed backward curved  
Maximum RPM 2695; 3/32 HP, class F, thermally protected

**Voltage** 120 VAC @ 60 Hz / 1 Phase

**Amperage** 1.5 A / 142 W

**Electronic Components** Circuit output voltage: 5VDC nominal  
RoHS compliant

**Heat Exchanger Exchange surface** Polypropylene HRV Core  
85 ft<sup>2</sup> (7.9 m<sup>2</sup>)  
**Dimensions** 12" L x 12" W x 10" D  
(304.8 mm x 304.8 mm x 254 mm)  
**Construction** Corrugated cross-flow polypropylene layers  
Recognized UL94 HB and HF-1

**Defrost type** Evacuation; activated automatically at 23°F (-5°C)

**Filters** Two Fiberbond washable 11-11/16"x9-3/4"x5/8"  
(297 mm x 248 mm x 16 mm)

**Drain Connection** 1/2" (12.7 mm)

**Actual Weight** 43 lbs (19.5 Kg)

**Shipping Weight** 48 1/2 lbs (22 Kg)

### Optional Wall Controls

**Mechanical** VHP-RD1, VHP-TC10 or VHP-DC15

**Timers** VHP-T3 (20, 40, 60 minutes)

### Wall Control Dimensions

#### VHP-RD1

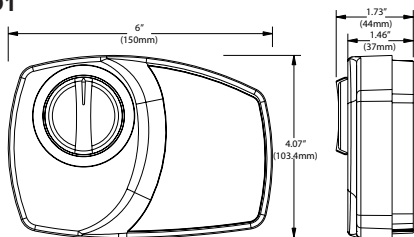

#### VHP-T3 Timer

and

VHP-TC10 /  
VHP-DC-15  
Wall Controls

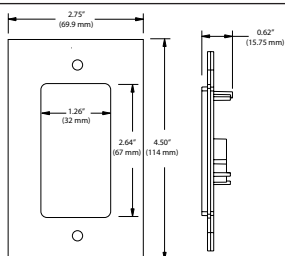

## Dimensional Data

### Front View

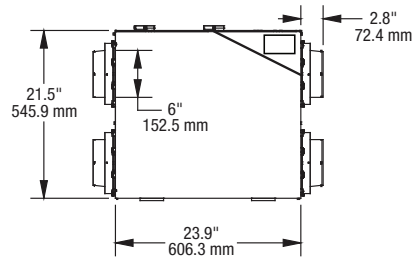

### Top View

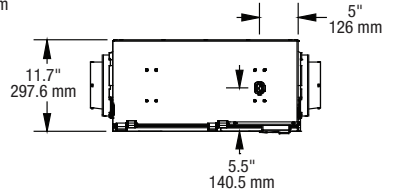

## Minimum Clearance Data

### Front View

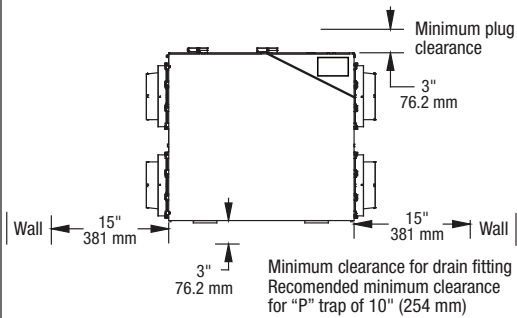

### Top View

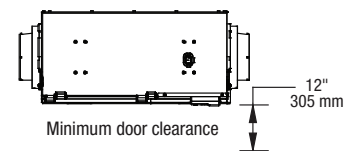

## Ventilation Performance

External Static Pressure	Net Supply Airflow		Gross Airflow Supply		Gross Airflow Exhaust		
	Pa	In. wg	L/s	CFM	L/s	CFM	
25	0.1	91	193	91	194	103	217
50	0.2	84	178	85	179	95	201
75	0.3	77	163	77	163	86	183
100	0.4	71	150	71	151	80	169
125	0.5	63	133	63	134	71	152
150	0.6	57	120	57	121	66	138
175	0.7	51	109	51	109	57	121

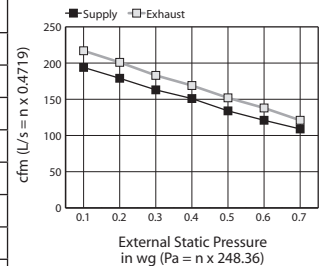

## Energy Performance

	Supply Temperature		Net Airflow		Power Consumed (Watts)	Sensible Recovery Efficiency	Adjusted Sensible Recovery Efficiency
	°C	°F	L/s	CFM			
Heating	0	32	31	65	72	66	73
	0	32	39	83	80	63	69
	0	32	50	107	94	60	66
	-25	-13	35	74	72	56	59

Our continuing commitment to quality products may mean a change in specifications without notice.

© 2017 • DAIKIN NORTH AMERICA LLC • Houston, Texas • Printed in the USA.